

Electrical Characteristics

Working Frequency	GPS:1575.42MHz GSM:824~894MHz, 880~960/1710~1900Mhz
V.S.W.R	GPS:1.5:1 GSM:2.0:1
Gain Coverage for GPS	> -4dBic at -90° < 0° < +90° (over 75% Volume)
Typical Gain for GSM	3dBi+/-1dB@850MHz; 3dBi+/-1dB@900MHz; 1dBi+/-1dB@1800MHz;
Polarization	RHCP
Impedance	50 Ohm



Material & Mechanical Characteristics

Material of Radiator	CU
Material of Plastic	Body:ABS
Material of Coaxial Cable	RG174/U
Connector Type	SMA Male

Environment

Operation Temperature	- 40°C~ + 85°C
Storage Temperature	- 45°C~ +100°C

Dimension

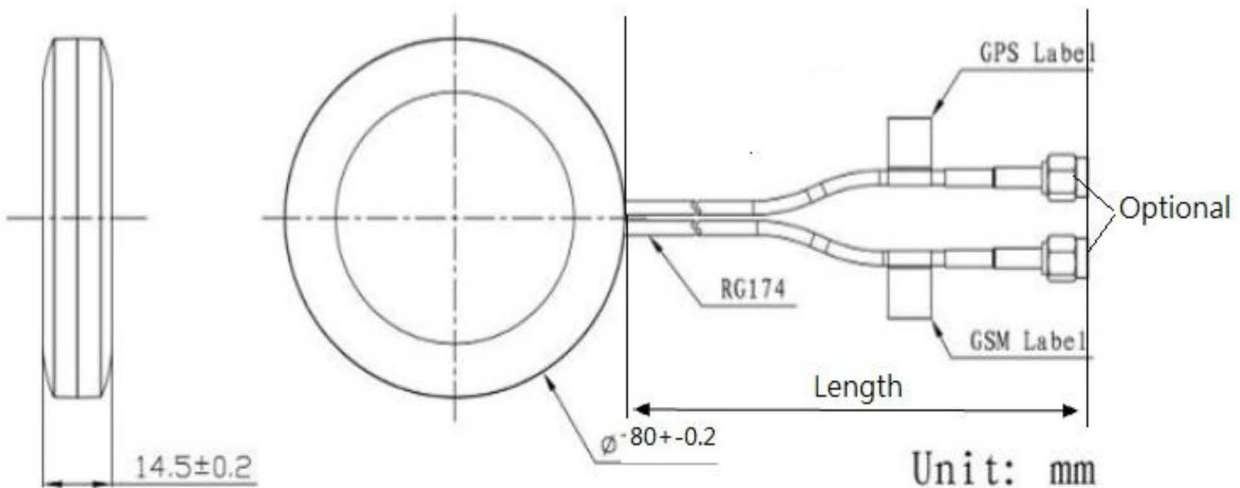

How to order

Series No.	Connector	Cable Type	Cable Length
SA80D	SMA, FME.. Optional	RG174... Optional	1 1: 1M Optional

Electrical Characteristics

Working Frequency	1575.42~1602Mhz
V.S.W.R	<1.5
Typical Antenna Gain	2dBi
Polarization	RHCP
Impedance	50 Ohm

Material & Mechanical Characteristics

Material of Radiator	CU
Material of Plastic	ABS
Material of Coaxial Cable	RG174/U
Connector Type	SMA Male

Environment

Operation Temperature	- 40°C~ + 85°C
Storage Temperature	- 40°C~ + 85°C

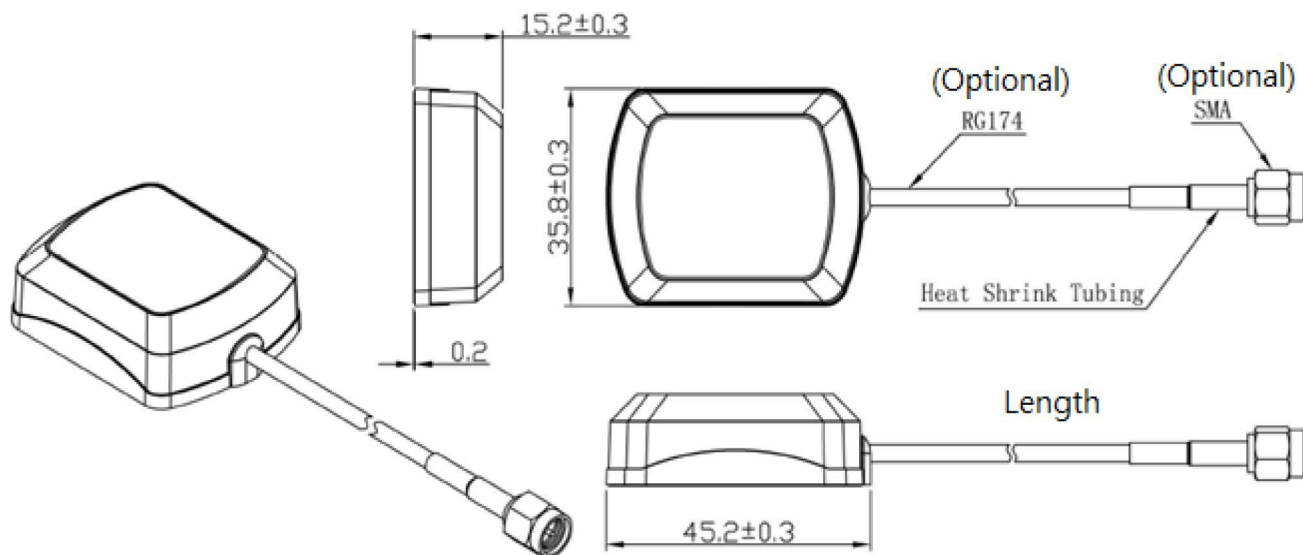
UNIT: mm
How to order

Series No.	Type	Type	Connector	Cable Type	Cable Length
SA	B1	02-A	01	A	5.0
	GPS / GLONASS (1602MHz)		01:SMA Male (Optional)	A:RG174 (Optional)	5.0M (Optional)

Electrical Characteristics

Working Frequency	GPS :1575.42±1.023 MHz GLONASS:1602±5 MHz
V.S.W.R	2.0:1
Typical Antenna Gain	30 dB
Polarization	Linear and Vertical, Horizontal
Impedance	50 Ohm

Material & Mechanical Characteristics

Material of Radiator	Cu
Material of Plastic	PVC+ABS
Material of Coaxial Cable	RG174U
Connector Type	SMA Male

Environment

Operation Temperature	- 35°C~ + 85°C
Storage Temperature	- 40°C~ + 95°C

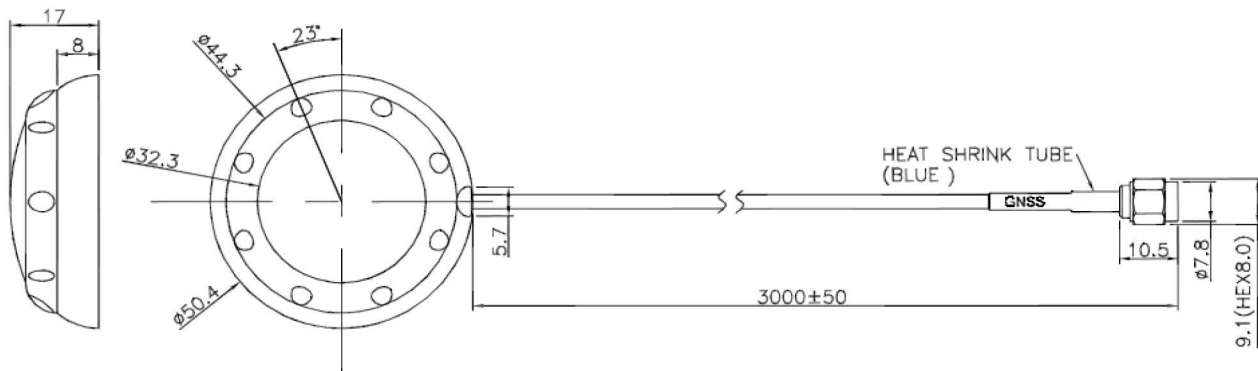

How to order

Series No.	Type	Type	Connector	Cable Type	Cable Length
SA	B1	04-A	01	A	3.0
	GPS / GLONASS (1602MHz)		01:SMA Male (Optional)	A:RG174 (Optional)	3.0M (Optional)